

H:\Data\2073 - Knightsbridge CDD Construction Series 2023\ENGR1 DWG\CDD Exhibit\Maintenance Map.dwg (11X17-CDD) JohnV, Jun 30, 2024 - 5:26pm

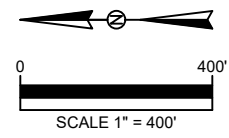
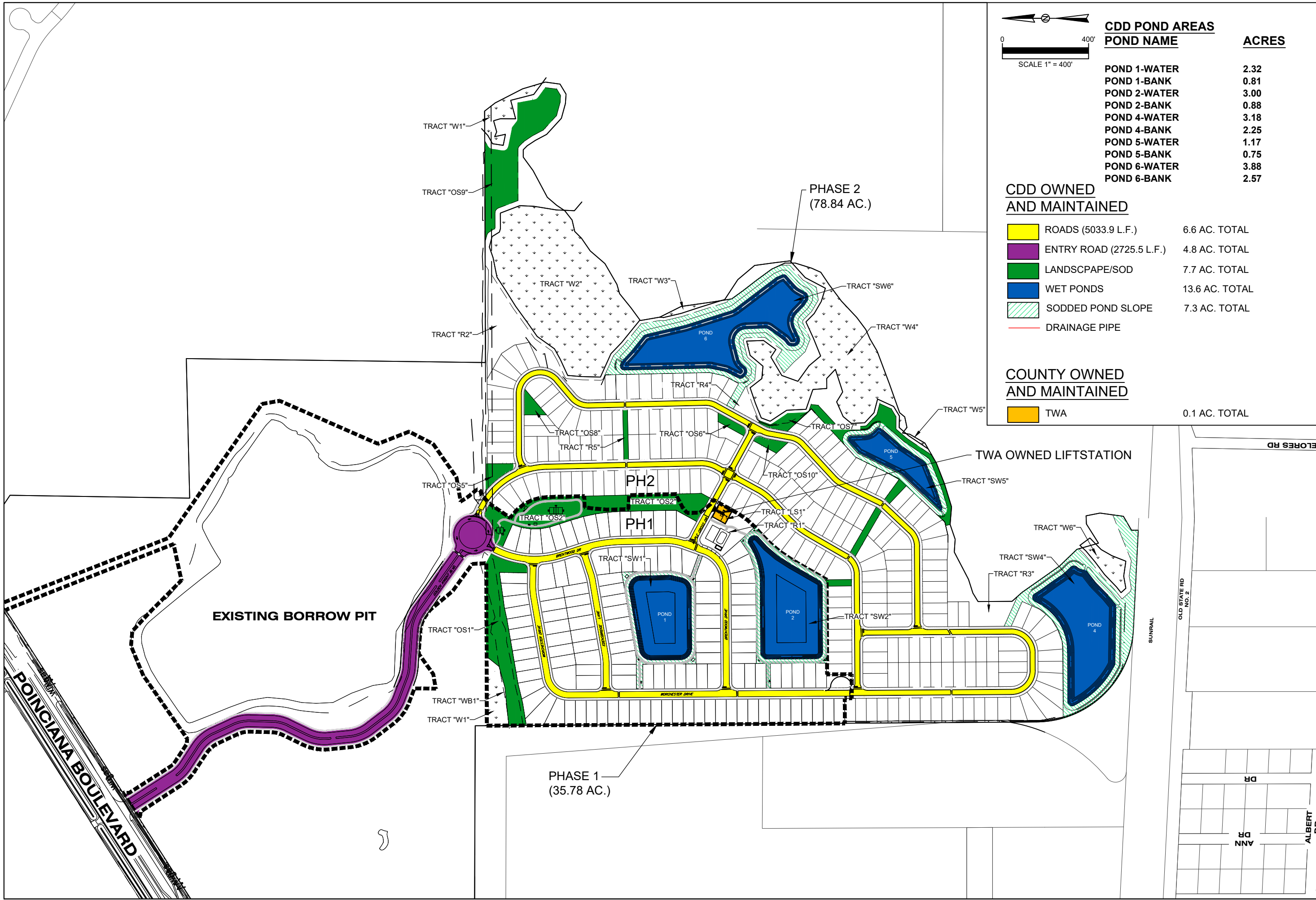

CDD POND AREAS	
POND NAME	ACRES
POND 1-WATER	2.32
POND 1-BANK	0.81
POND 2-WATER	3.00
POND 2-BANK	0.88
POND 4-WATER	3.18
POND 4-BANK	2.25
POND 5-WATER	1.17
POND 5-BANK	0.75
POND 6-WATER	3.88
POND 6-BANK	2.57

CDD OWNED AND MAINTAINED	
ROADS (5033.9 L.F.)	6.6 AC. TOTAL
ENTRY ROAD (2725.5 L.F.)	4.8 AC. TOTAL
LANDSCAPE/SOD	7.7 AC. TOTAL
WET PONDS	13.6 AC. TOTAL
SODDED POND SLOPE	7.3 AC. TOTAL
DRAINAGE PIPE	

COUNTY OWNED AND MAINTAINED	
TWA	0.1 AC. TOTAL

MAINTENANCE MAP - CDD
KNIGHTSBRIDGE COMMUNITY DEVELOPMENT DISTRICT

HAMILTON
ENGINEERING & SURVEYING, LLC.
3409 W LEMON ST
TAMPA, FL 33609
TEL: 813.256.3535
www.HamiltonEngineering.us

431 E HORATIO AVE.
STE 260
MANTLAND, FL 32751
TEL: 407.362.9929

JOB NUMBER	53509.0018
DATE	01/30/24
DRAWN BY	JV
EXHIBIT	6A

SEC TWP RGE
35, 36-25S-28E